



CUSTOM GALLERIES

Meridian



Blackford

This English manor home delivers a new class of style. With a main-floor master suite, 4 and 5 bedrooms, 3 and 4 baths, finished lower level and a 3-car garage, - this home honors the style from the past and blends it with the conveniences of today.

Plan #	Sq Ft.	Master	Price
7030	3416	Main	\$470000-495000

The Blackford is part of our Meridian Gallery. These plans offer an impressive array of custom designs for those who want a low-maintenance lifestyle that includes luxury features and amenities that add enduring value to your home.





Main Level

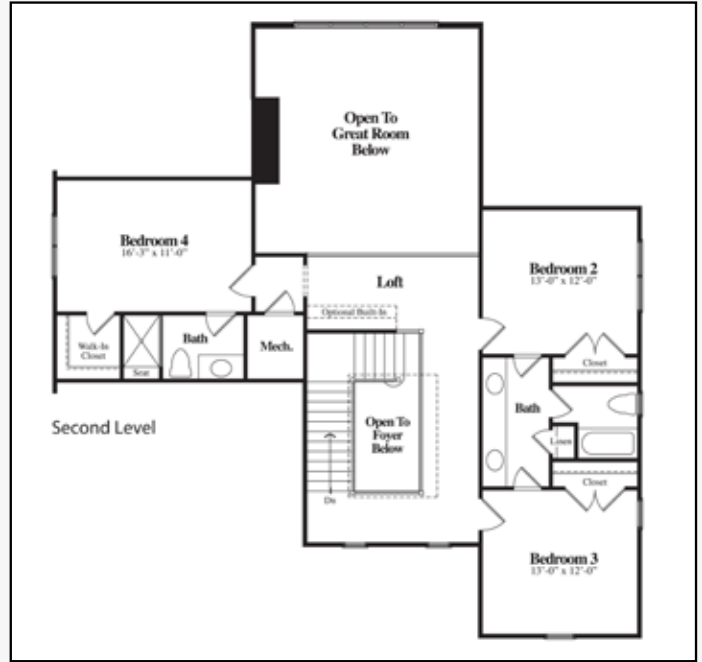

Upper Level

Blackford

Plan Number: 7030

Price: \$470000-495000

Square Feet: 3416

Master Bedroom: Main

Beds: 4-5

Full Baths: 3-4

1/2 Baths: 1

Lower Level: Finished

Garage: 3

LOWER LEVEL

This home is built with a completely finished lower level with 10 ft. ceilings and individualized custom designs and features.

Lower Level

In our continuing effort to meet homebuyer's expectations, we reserve the right to modify features, price, specifications and/or to change or discontinue models without notice or obligation. Floor plan dimensions are approximate. Room dimensions do not include optional bays or box-outs. Floor plan shown may vary from actual home. Ceiling designs vary per elevation. Copyright 2013.



CUSTOM GALLERIES

12965 Old Meridian Street
 Carmel, IN 46032
 317.582.2464
 www.estrledge.com

Blackford



Main Level



Upper Level

